



GOVERNMENT OF DUBAI

دائرة الأراضي والأموال  
Land Department



NAME:	الاسم
PLOT NO: <b>2509 (513-7676)</b>	رقم القطعة: <b>2509</b>
BLOCK: <b>Saih Shuaib 1 (513)</b>	المنطقة: <b>سيح شعيب 1 (513)</b>
TOTAL AREA: <b>979/50 SQ.M. (10543/25 SQ.FT.)</b>	المساحة الكلية: <b>979/50 SQ.M. (10543/25 SQ.FT.)</b>

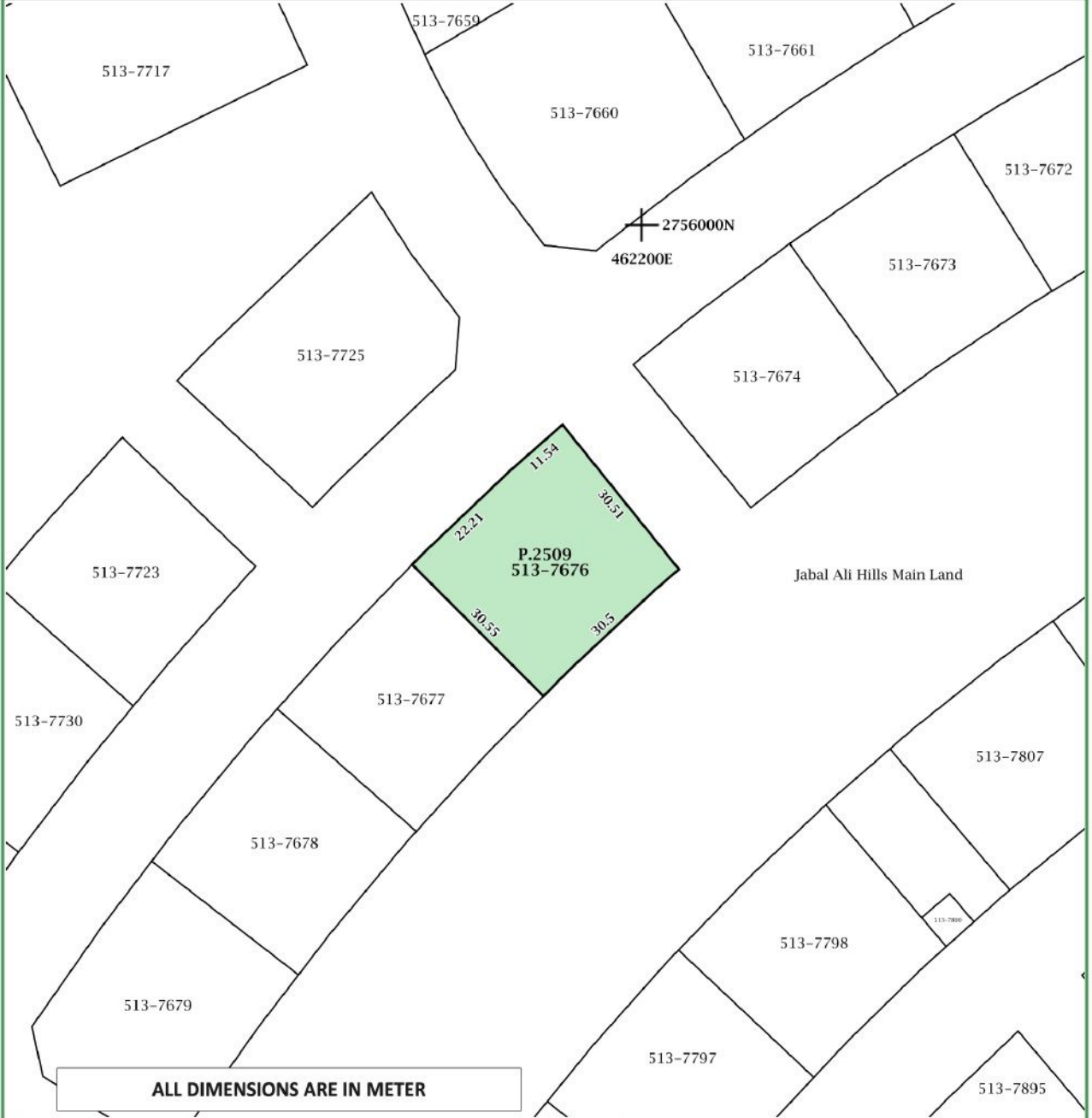

ALL DIMENSIONS ARE IN METER

PROJECT: <b>Jabal Ali Hills</b>	STATUS: <b>VACANT</b>	<b>PLOT SITE PLAN</b>	
SUBDIVIDED FROM: <b>P.27 (513-0) Saih Shuaib 1</b>		MAP REF. NO. : <b>24542354/2023</b>	
REFERENCE: <b>As Per Planning</b>	DATED: <b>16/01/2023</b>	<b>وثيقة معتمدة إلكترونياً</b>	
PREVIOUS REG:	ORIGIN: <b>Private</b>		
PLAN TYPE: <b>THEORETICAL</b>			
RESURVEYED BY:	DATED:		
DEVELOPER REF: <b>JAH-PA-05-020</b>	SCALE: <b>1:1100</b>		
PREPARED BY: <b>SYSTEM</b>	ISSUED ON: <b>16/01/2023</b>	<b>CERTIFIED Electronically</b>	