



GOVERNMENT OF DUBAI

دائرة الأراضي والأموال  
Land Department



NAME:	الاسم
PLOT NO: <b>1206 (665-9759)</b>	رقم القطعة: <b>1206</b>
BLOCK: <b>Wadi Al Safa 7 (665)</b>	المنطقة: <b>وادي الصفا 7 (665)</b>
TOTAL AREA: <b>2555/70 SQ.M. (27509/33 SQ.FT.)</b>	المساحة الكلية: <b>2555/70 SQ.M. (27509/33 SQ.FT.)</b>

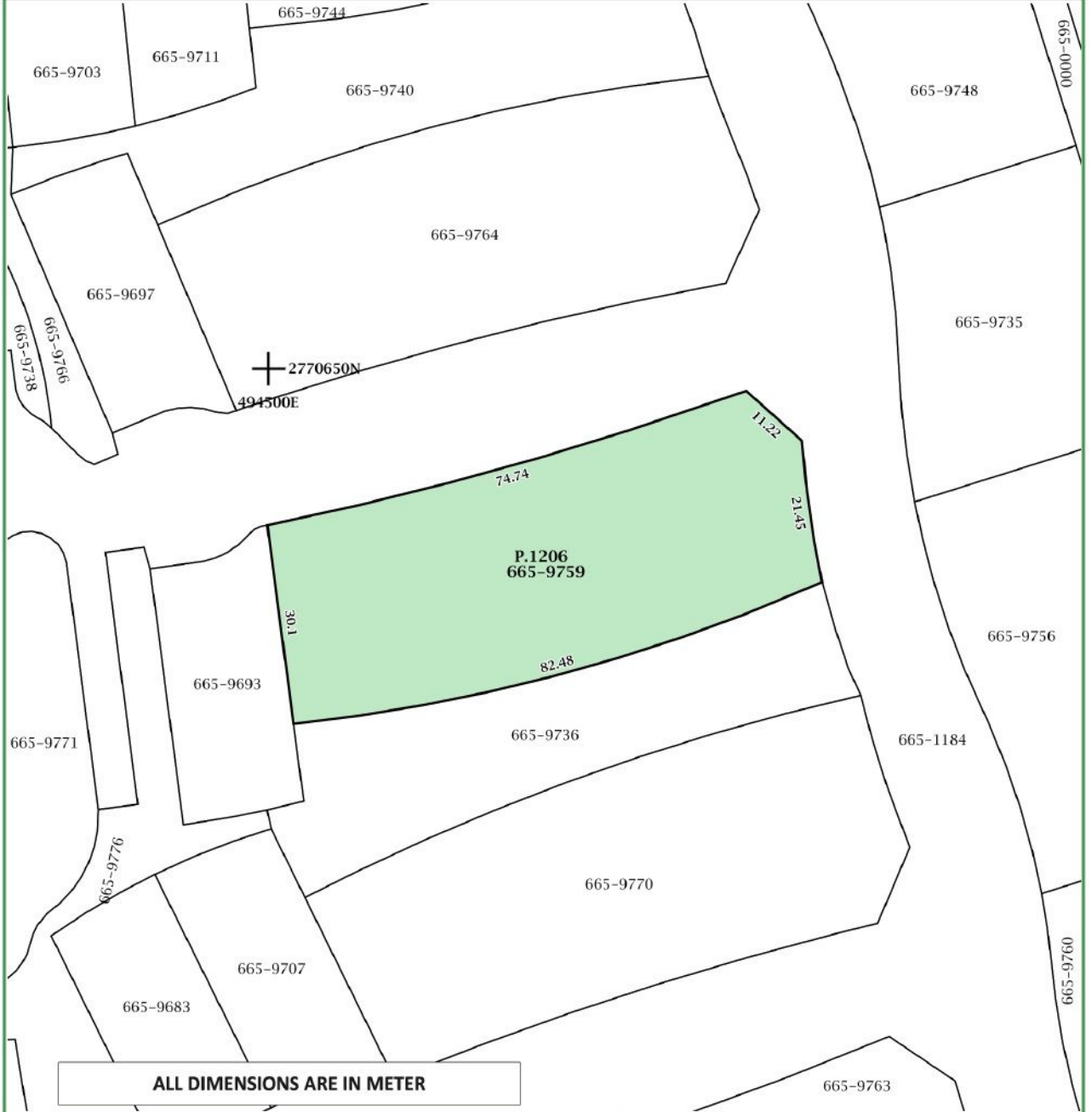

PROJECT: <b>The Palmarosa</b>	STATUS: <b>PREMISED</b>	<b>PLOT SITE PLAN</b>	
SUBDIVIDED FROM: <b>P.1116 (665-1184) Wadi Al Safa 7</b>		MAP REF. NO. : <b>306611/2023</b>	
REFERENCE: <b>As Per Planning</b>	DATED: <b>03/01/2023</b>	وثيقة معتمدة إلكترونياً	
PREVIOUS REG:	ORIGIN: <b>Private</b>		
PLAN TYPE: <b>THEORETICAL</b>		<b>CERTIFIED Electronically</b>	
RESURVEYED BY:	DATED:		
DEVELOPER REF:	SCALE: <b>1:1000</b>		
PREPARED BY: <b>SYSTEM</b>	ISSUED ON: <b>03/01/2023</b>		