

UNIT DETAIL		بيانات الوحدة	
UNIT NO: 410A (OFFICE)		رقم الوحدة: 410A (مكتب)	
UNIT AREA:	61.48 SQ.M (661.77 SQ.FT)	مساحة الوحدة:	
BALCONY AREA:	000.00 SQ.M (0000.00 SQ.FT)	مساحة البلكونة:	
TOTAL AREA:	61.48 SQ.M (661.77 SQ.FT)	المساحة الكلية:	
UTILITY AREA:	00.00 SQ.M (00.00 SQ.FT)	المرافق العامة:	
PARKING ALLOCATION TYPE: TITLE		PARKING ALLOCATION BAY: -	

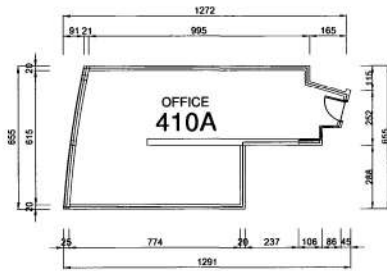

UNIT DETAIL  
SCALE: NTS

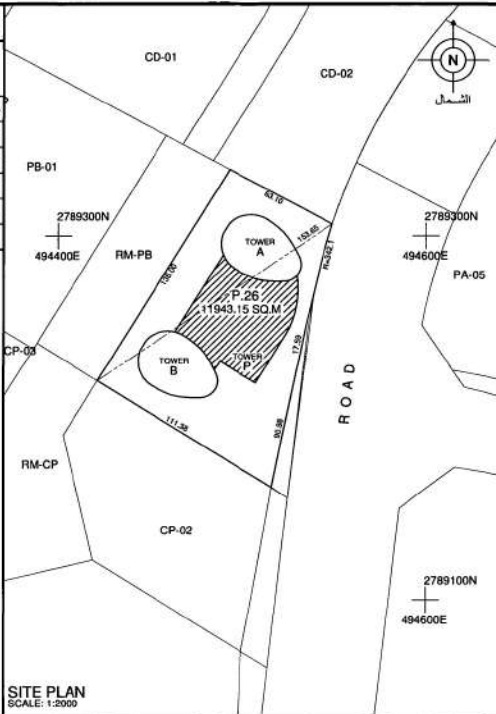

SITE PLAN  
SCALE: 1:2000

UNIT LOCATION IN BUILDING

موقع الوحدة في المبنى

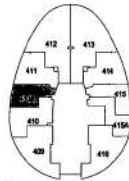

FLOOR 4  
SCALE: NTS

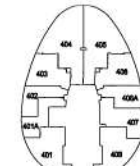

Plot No: 26	(337-0)	رقم القطعة: 26	(337-0)
BLOCK: ZA'ABEEL SECOND (337)		المنطقة: زعبيل الثانية (337)	
TOTAL AREA: 11943.15 SQ.M (128555.00 SQ.FT)			
مجموع المساحة: 11943.15 متر مربع (128555.00 قدم مربع)			
SITE PLAN: P.26		DATED: 12/10/2014	
SUBDIVIDED FROM: P.7 (337-457) ZAABEEL SECOND			
PLOT REFERENCE: DIFC-PB-02 DATED: 20/08/2007			

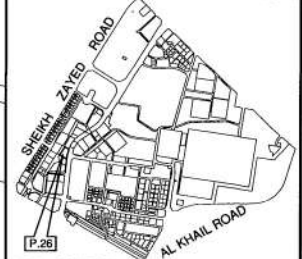

KEY LOCATION

PROJECT NAME:	DIFC
PREPARED BY:	EMARAT SURVEY SERVICES
SURVEY STATUS:	YES
DATED:	13/09/2011
ISSUED ON:	09/04/2015
BUILDING NAME & NO.:	PARK TOWERS PODIUM-3
DIFC LOT NO.:	رقم القطعة:
FOLIO NO.:	
STRATA SCHEME NAME:	
UNIT REFERENCE:	410A

UNIT SITE PLAN

SHEET 1 OF 1
DLD APPROVAL:
 دائرة الأراضي والأماك Land Department رقم ترخيص: 280
DIRECTOR